

CHURCH



Garden Suite 5 with walk-out to large garden.

**PLAN 12**  
**1 BEDROOM**  
**851 SQ.FT.**

C210 identical lay-out above, without outdoor space.

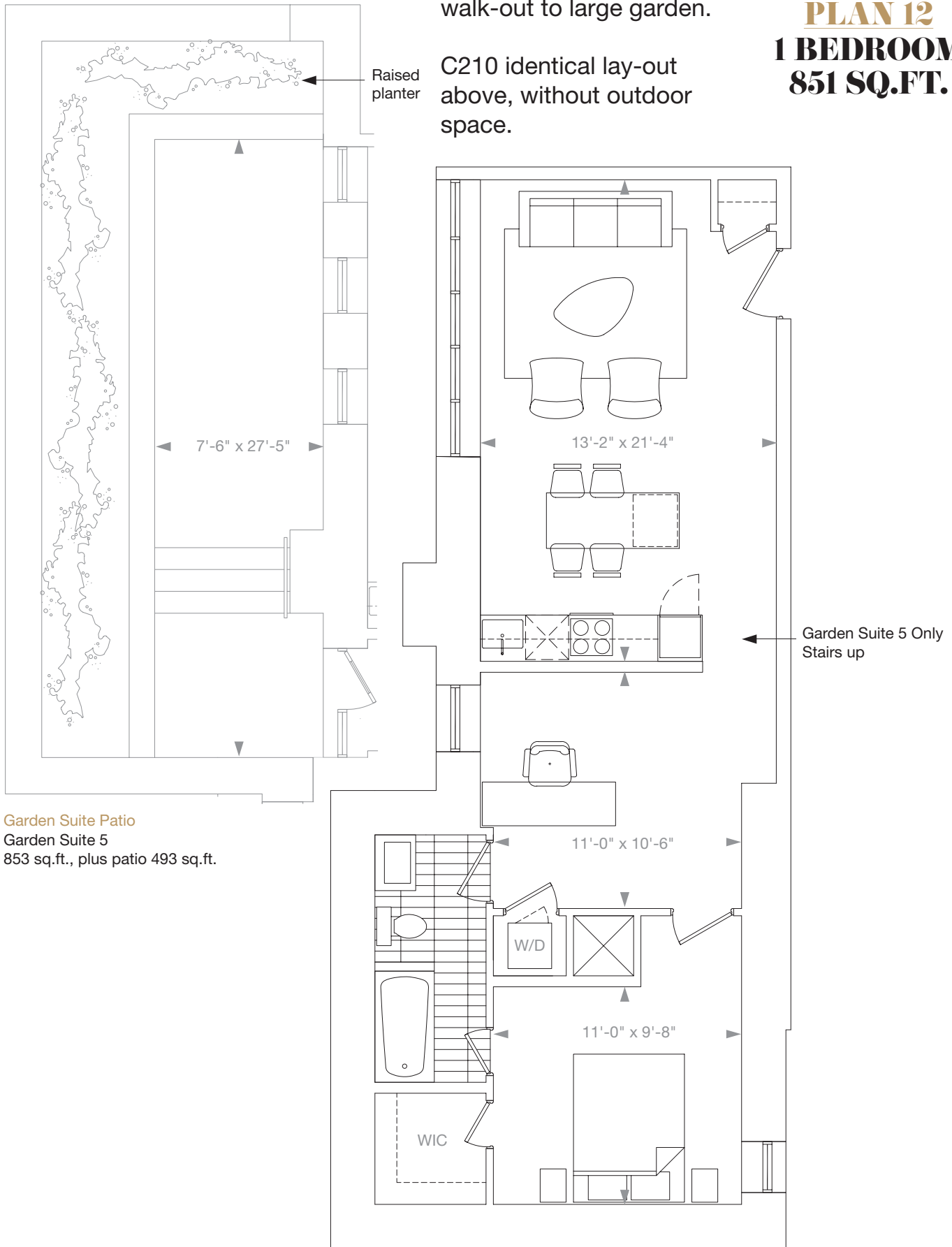

**Garden Suite Patio**  
Garden Suite 5  
853 sq.ft., plus patio 493 sq.ft.

C210

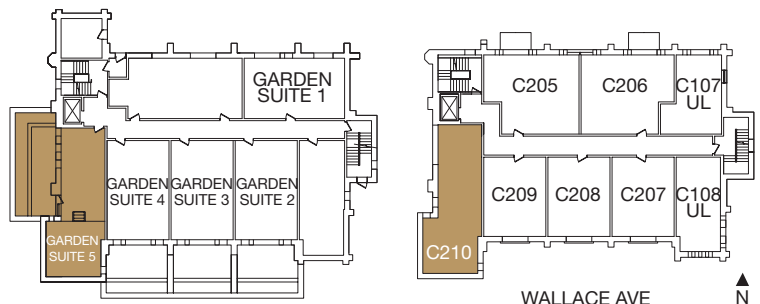

All areas and stated room dimensions are approximate. Sizes and specifications are subject to change without notice. E. & O. E.